

REAR WINDOW MSP 2024/TOYOTA LAND CRUISER AC7702801NA

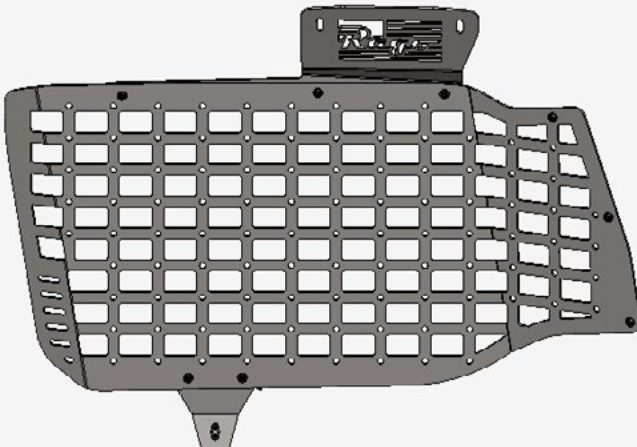
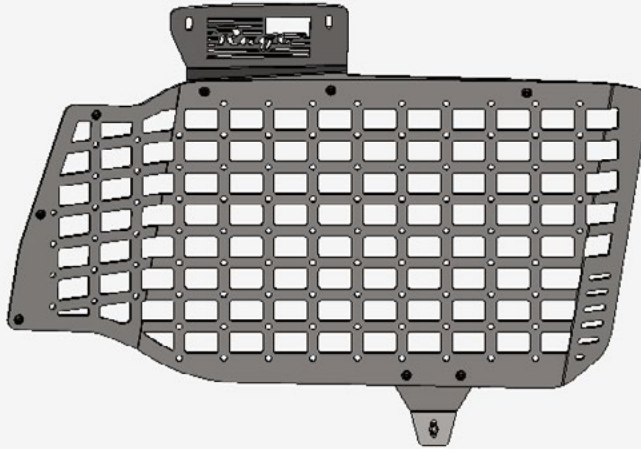

TOOLS REQUIRED

- 10mm, 7/16 sockets
- 10mm, 7/16 wrenches
- Pushpin Puller or Flathead Screwdriver
 - Marker
- 5/32, 5mm Hex
 - Drill
- Step Up Drill Bit

SKILL LEVEL

- Easy

TIME REQUIRED

- Approximately 1 Hour

WARNINGS/CAUTIONS BEFORE STARTING INSTALLATION

-BEFORE YOU INSTALL THIS KIT-

Read and understand all instructions, warnings, cautions, & notes contained in this installation instruction guide. Consult your vehicle owner's manual for proper disconnection of electrical and lifting of vehicle if required for installation of this product.

This install may require some technical skills and knowledge of basic mechanical work. If you do not feel that you are capable of performing this install please take this product to a trained professional.

After reading this guide please contact us with any questions or concerns before installing product.

Customer Service: 830-896-7571
Rago Fabrication is **not** responsible for any bodily injury or harm to you or your vehicle as a result of an improper install.

Proper installation of this kit required knowledge of the factory recommended procedures for removal and installation of original equipment components.

We recommend that the factory shop manual and any special tools needed to service your vehicle be on hand during the installation. Installation of this kit without proper knowledge of the factory recommended procedures may affect the

performance of these components and the safety of the vehicle. Inspect all contents of this package to make sure product is not damaged and all installation hardware has been included. If parts are missing from kit, please be prepared to provide the following information:

1. Name of purchase location
2. Bar Code on side of box
3. Date above bar code
4. Date inside box cover

***ALWAYS WEAR EYE PROTECTION
WHEN OPERATING POWER TOOLS***

HARDWARE

A.

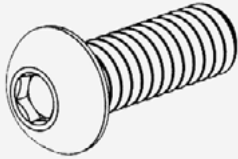

1/4-20 X 3/4" BUTTON HEAD

QTY: 16

A1.



1/4" FLAT WASHER

QTY: 10

A2.

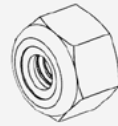

1/4-20" NYLON LOCK NUT

QTY: 10

B.

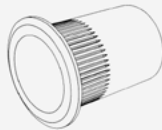

1/4-20 Rivet Nut

QTY: 6

C.

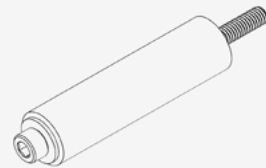

MPL0007

QTY: 2

Reference this page throughout the install



□ STEP 1

Remove the grab handle and cover shown below using a (flathead screwdriver).



□ STEP 2

Using a (10mm socket), remove the OEM hardware shown below. ****KEEP HARDWARE****



□ STEP 3

Install the provided (C) spacer into the bottom mounting hole.



□ STEP 4

With the provided (A, A1, A2) 1/4" hardware install the top mounting bracket using a (5/32 allen) and a (7/16 wrench).

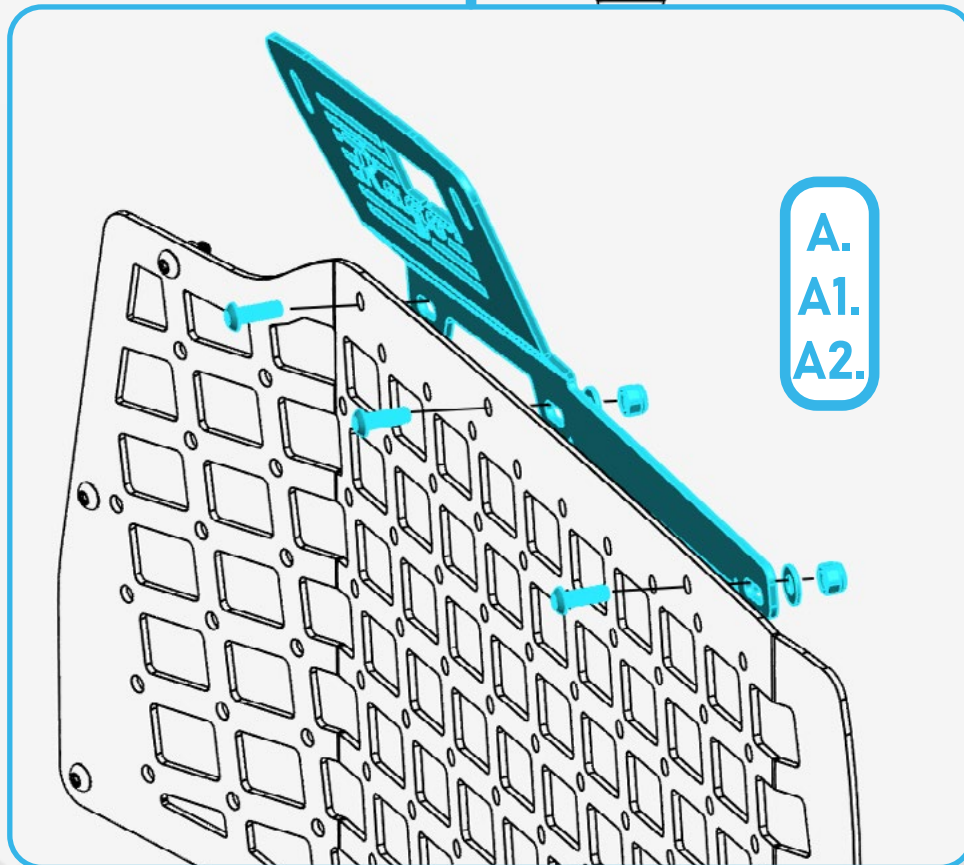
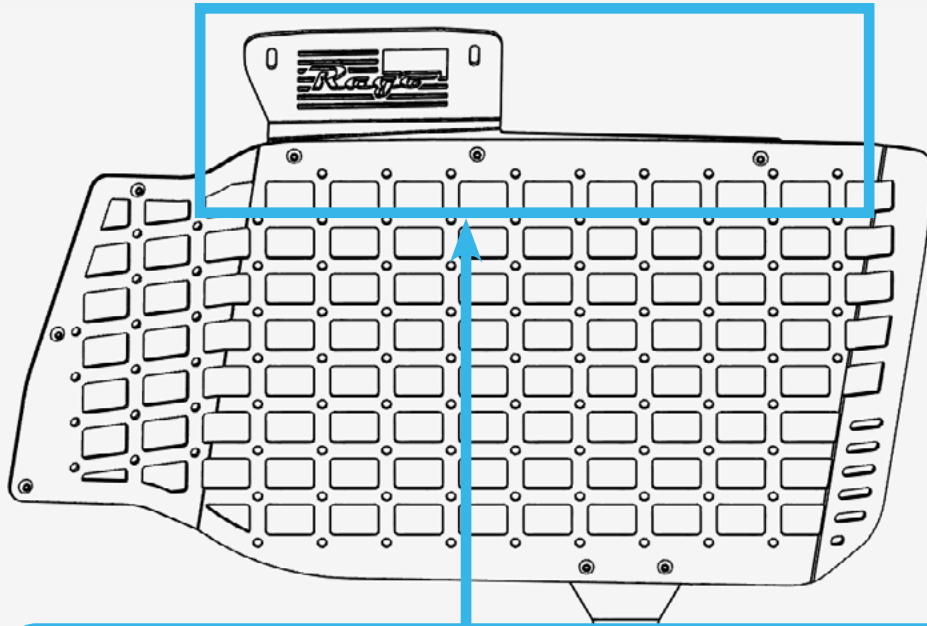

□ STEP 5

With the provided (A, A1, A2) 1/4" hardware, install the bottom mounting bracket using a (5/32 allen) and a (7/16 wrench).

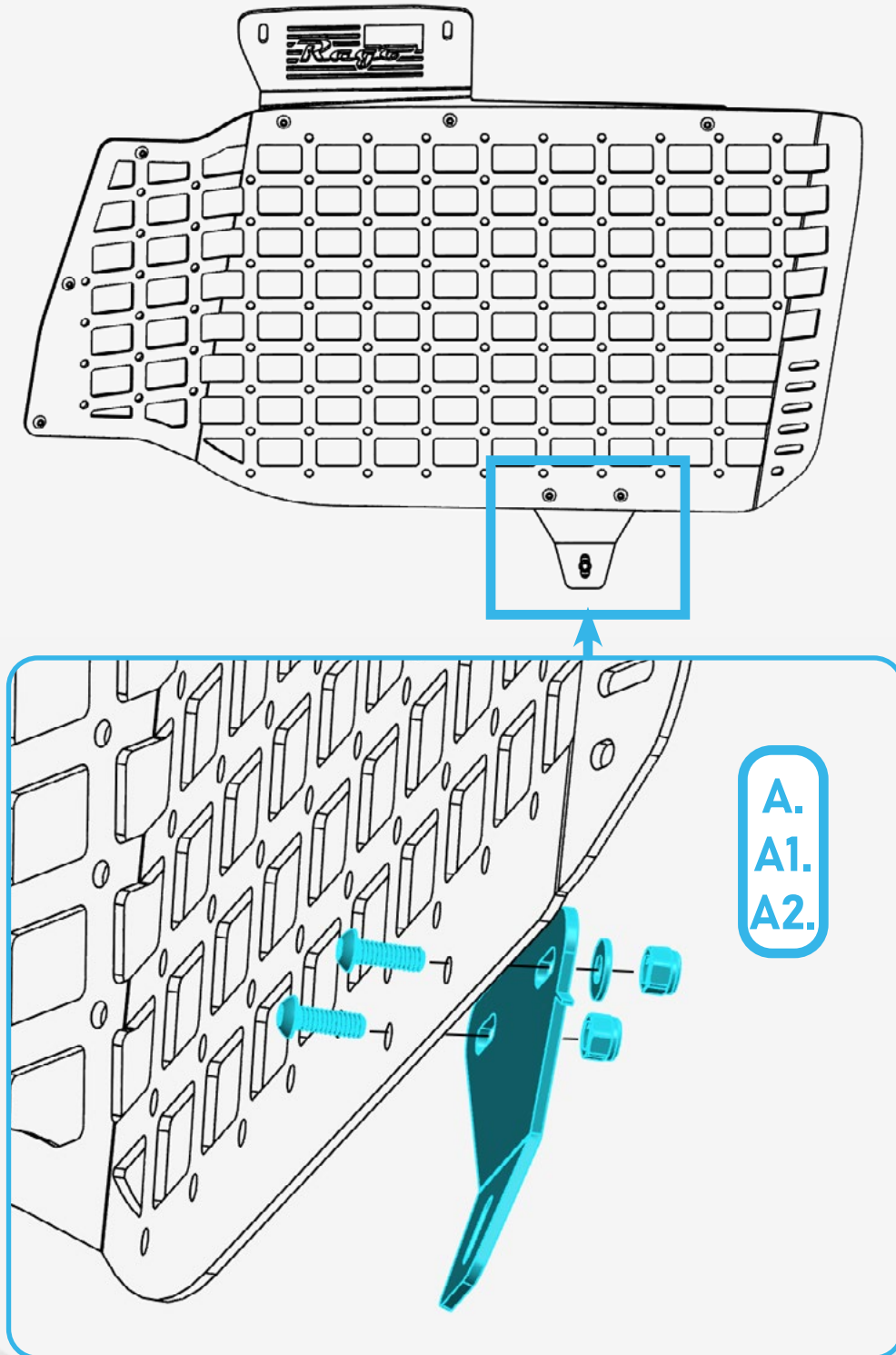

□ STEP 6

Install the molle panel with the hardware removed from **step 2** for the top mount using a (10mm socket) and install the provided (C) hardware that came with the spacer into the bottom mount using a (HW5 allen).



□ STEP 7

Using a marker, mark the holes highlighted below and remove the panel.



□ STEP 8

Using a (step up drill bit), drill a hole no more than 7/16 on the marked holes from **step 7**.



□ STEP 9

Using a (rivet nut tool), install the provided (B) 1/4" rivet nut into the holes drilled in **step 8**.



STEP 10

If you have purchased a **AC7703001NA- Rear Shelf**, Refer to the install guide on the website before moving on to the next step.



□ STEP 11

Re-install the molle panel and install the provided (A) 1/4" hardware into the rivet nut installed on step 9.



□ STEP 12

(OPTIONAL) Install the grab handle before fully tightening all hardware.



STEP 13

Stand back and enjoy your new RAGO Rear Window MSP.

Check and re-tighten all mounting bolts after 100 miles and periodically thereafter.

